

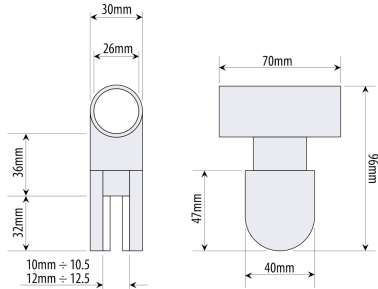

## Upper Panel Holder ( Model: KP551 )



- The upper panel is made of stainless steel AISI 316L.
- It should be slipped on the upper rail tube.
- The glass is blocked between the two parts of the panel holder.
- It is not necessary to drill the glass panel.

### Attributes:

**Product Code:** KP551

**Unit Of Sale:** Each