



# Countersunk Fixed Bolt For 22 - 26mm Thick Glass (Outside Fi ( Model: KSP.V2002-2226-1266 )

These items are not held in stock and will require approximately 1-2 weeks delivery time



### Attributes:

Product Code: KSP.V2002-2226-1266

Unit Of Sale: Each

### Dimensions

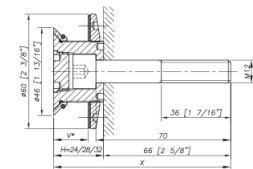

H= Sanket body corresponding to the thickness of the glass.  
V= glass thickness.

### Components

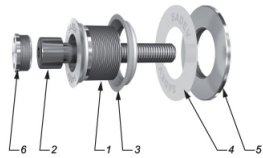

MARK	QUANTITY	DESCRIPTION	MATERIAL
1	1	Body	X2 CrNiMo 17.12.2 as per EN 10088-5
2	1	Ball (EN1212-75)	A4
3	1	Glass hole grommet	AW 1055 as per EN 675.3 / AW 66.6
4	1	Control washer	White epoxy / white epoxythane
5	1	Glass nut Ø 80	X2 CrNiMo 17.12.2 as per EN 10088-5
6	1	Clear cap	X2 CrNiMo 17.12.2 as per EN 10088-5

### Glass Drilling

#### Monolithic glass

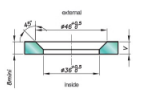

#### Laminated glass V = 1" glass + intercalated film + 2" glass

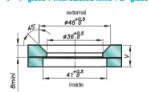

Available for glass thicknesses from 6 to 31.5mm, for other thicknesses please contact us.

It is required to provide the following information with each request: the glass composition (ex.: 10mm monolithic, 6+6 laminated, 6+6+2+10 laminated) / the length and diameter of the intended hole if not standard dimensions (M14, 60 diam) / the reference of the spigot to be used as support, or the thickness of an existing support for the safety of the spigot.

### Mechanical Performance

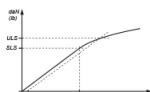

After strength	Pull out capacity
4.52	4.52
4342 daN (9761 lb)	3709 daN (8338 lb)

\*ULS - Ultimate Limit State / load at the elastic limit (EN 1) Values are given without factor of safety

\*\*SN: Tensile strength calculation according to EN 1993-1-8 and shear strength calculation according to EN 1993-1-4